

# Crawford QCSD Short Quick Change Collet Chucks

## for Multibore DIN Standard type Collets

- ⌚ Short Body design, ideal for bar work with limited working envelope.
- ⌚ Dead Length Operation
- ⌚ Large Capacity- QCSD Chuck maximum round is 2.36" (60mm).
- ⌚ QCSD uses Multi-Bore Din Collets
- ⌚ Collets have 1/8" range per Collet and available for Round, Hex or Square parts.
- ⌚ Save set up time-Quick Change Bayonet Cap Design.
- ⌚ Accurate-.0002" TIR from rear mounting register and working collet taper.
- ⌚ Repeatability .0002" on duplicate parts.
- ⌚ Available in A type and Din 55026 other mountings available upon request.
- ⌚ 1 Year Warranty

Use Din 6343 Multibore Collets see page 124

- (1) Each collet size requires a polyurethane chip Chuck Seal.
- (2) Additional Quick Change Chuck Caps can be ordered for pre-loading collets and further reducing downtime.

C† Maximum drawtube thread 'C'

D† Maximum drawtube length retracted 'D'

E† Maximum forward stroke required

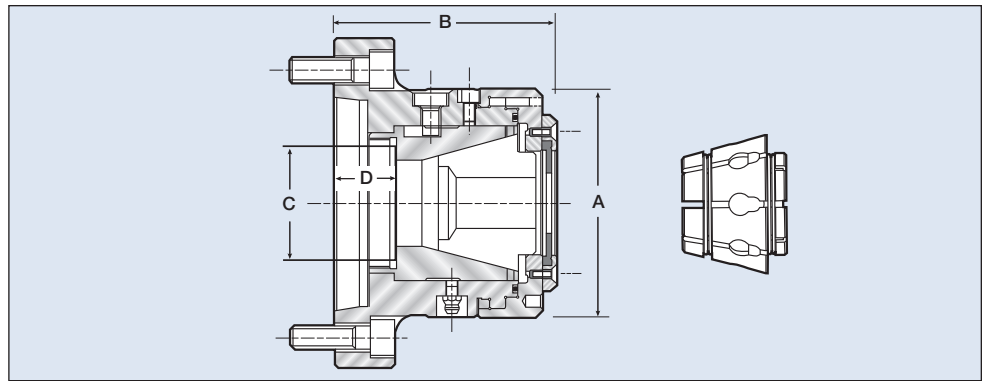

### QCSD Series for Multibore DIN Standard type Collets

Chuck Type	QCSD-42	QCSD-42	QCSD-60	QCSD-60
Mount	A2-5	A2-6	A2-6	A2-8
Collet Type Multibore DIN	M-673	M-673	M-677	M-677
Capacity Round (mm/in)	42/1.65	42/1.65	60/2.36	60/2.36
Capacity Hex (mm/in)	36/1.41	36/1.41	52/2.04	52/2.04
Capacity Square (mm/in)	29/1.14	29/1.14	42/1.65	42/1.65
A (mm/in)	114/4.49	114/4.49	146/5.75	146/5.75
B (mm/in)	110/4.33	110/4.33	136/5.35	136/5.35
C† (mm/in)	60/2.36	60/2.36	70/2.76	70/2.76
D† (mm/in)	31/1.22	31/1.22	48/1.89	48/1.89
E† (mm/in)	9/.35	9/.35	10/.39	10/.39
Chuck Weight	15 lbs	15.4 lbs	22 lbs	30.9 lbs
Drawbar Force (lb/f)	5,392	5,392	8,536	8,536
Clamping Force (lb/f)	13,199	13,199	22,200	22,200
Maximum RPM	6000	6000	6000	4500
(1)Chuck Seal Part No.	D-237	D-237	D-485	D-485
(2)Chuck Cap Part No.	C-428GA	C-428GA	D-142GA	D-142GA
Chuck Order No.	D-607	D-608	D-609	D-610

HOW TO ORDER: State quantity, Model Number of chuck and shipping instructions.