

Crawford QCS Short Quick Change Collet Chucks

for Multibore Crawford Standard type Collets

Uses Standard Multibore Collets see page 122

- (1) Each collet size requires a polyurethane chip Chuck Seal.
- (2) Additional Quick Change Chuck Caps can be ordered for pre-loading collets and further reducing downtime.

C† Maximum drawtube thread 'C'

D† Maximum drawtube length retracted 'D'

E† Maximum forward stroke required

- ⌚ Short Body design, ideal for bar work with limited working envelope.
- ⌚ Dead Length Operation
- ⌚ Large Capacity- QSC Chuck maximum round 3.07" (80mm) Q
- ⌚ QSC uses Multi-Bore Collets
- ⌚ Collets have 1/8" range per Collet and available for Round, Hex or Square parts.
- ⌚ Save set up time-Quick Change Bayonet Cap Design.
- ⌚ Accurate-.0002" TIR from rear mounting register and working collet taper.
- ⌚ Repeatability .0002" on duplicate parts.
- ⌚ Available in A type and Din 55026 other mountings available upon request.
- ⌚ 1 Year Warranty

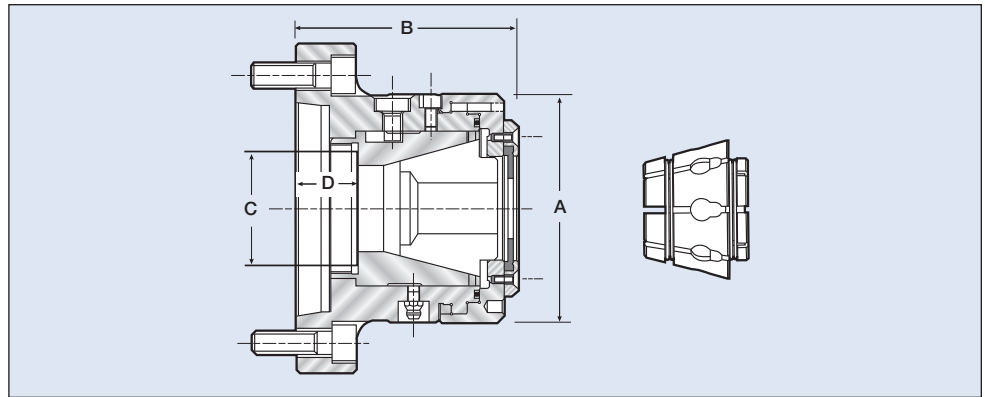

QCS Series for Multibore Crawford Standard type Collets

Chuck Type	QCS-28	QCS-42	QCS-42	QCS-54	QCS-54	QCS-66	QCS-80
Mount	A2-5	A2-5	A2-6	A2-6	A2-8	A2-8	A2-8
Collet Type Multibore	T980	W-850	W-850	V-120	V-120	T-285	N-175
Capacity Round (mm/in)	28/1.26	42/1.65	42/1.65	54/2.12	54/2.12	66/2.59	80/3.15
Capacity Hex (mm/in)	25/1.00	36/1.41	36/1.41	51/2.00	51/2.00	57/2.24	69/2.71
Capacity Square (mm/in)	19/.75	31/1.22	31/1.22	41/1.61	41/1.61	44/1.78	56/2.20
A (mm/in)	95	114/4.49	114/4.49	146/5.75	146/5.75	166/6.54	205/8.07
B (mm/in)	112	110/4.33	110/4.33	140/5.51	140/5.51	155/6.10	170/6.69
C† (mm/in)	.40	60/2.36	60/2.36	70/2.76	70/2.76	88/3.46	88/3.46
D† (mm/in)	.31	31/1.22	31/1.22	48/1.89	48/1.89	48/1.89	58/2.28
E† (mm/in)	9	9/.35	9/.35	10/.39	10/.39	10/.39	12/.47
Chuck Weight	11 lbs	15 lbs	15.4 lbs	22 lbs	30.9 lbs	39 lbs	55.1 lbs
Drawbar Force (lb/f)	4,037	5,392	5,392	8,536	8,536	8,536	9,885
Clamping Force (lb/f)	9,878	13,199	13,199	22,200	22,200	22,200	25,699
Maximum RPM	6000	6000	6000	6000	4500	4500	4000
(1)Chuck Seal Part No.	D-819	D-237	D-237	D-485	D-485	D-619	D-527
(2)Chuck Cap Part No.	C-555GA	C-68GA	C-68GA	D-983GA	D-983GA	C-556GA	C-492GA
Chuck Order No.	C-19	D-603	D-428	D-604	D-605	D-606	D-548

HOW TO ORDER: State quantity, Model Number of chuck and shipping instructions.