

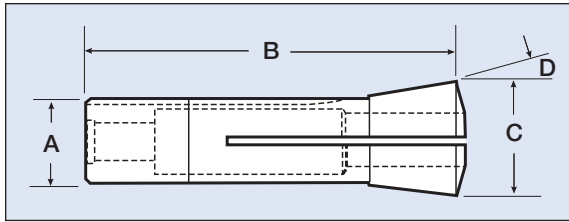

# Crawford R8 Collets



Dimensions

A	B	C	D
.95"	4.05"	1.24"	8°25'

Size	R8 (inch) Part Number
1/16"	Z384-R-1/16"
3/32"	Z384-R-3/32"
1/8"	Z384-R-1/8"
5/32"	Z384-R-5/32"
3/16"	Z384-R-3/16"
7/32"	Z384-R-7/32"
1/4"	Z384-R-1/4"
9/32"	Z384-R-9/32"
5/16"	Z384-R-5/16"
11/32"	Z384-R-11/32"
3/8"	Z384-R-3/8"
13/32"	Z384-R-13/32"
7/16"	Z384-R-7/16"
15/32"	Z384-R-15/32"
1/2"	Z384-R-1/2"
17/32"	Z384-R-17/32"
9/16"	Z384-R-9/16"
19/32"	Z384-R-19/32"
5/8"	Z384-R-5/8"
21/32"	Z384-R-21/32"
11/16"	Z384-R-11/16"
23/32"	Z384-R-23/32"
3/4"	Z384-R-3/4"
25/32"	Z384-R-25/32"
13/16"	Z384-R-13/16"
27/32"	Z384-R-27/32"

Size	R8 (metric) Part Number
2mm	Z384-R-2mm
3mm	Z384-R-3mm
4mm	Z384-R-4mm
5mm	Z384-R-5mm
6mm	Z384-R-6mm
7mm	Z384-R-7mm
8mm	Z384-R-8mm
9mm	Z384-R-9mm
10mm	Z384-R-10mm
11mm	Z384-R-11mm
12mm	Z384-R-12mm
13mm	Z384-R-13mm
14mm	Z384-R-14mm
15mm	Z384-R-15mm
16mm	Z384-R-16mm
17mm	Z384-R-17mm
18mm	Z384-R-18mm
19mm	Z384-R-19mm
20mm	Z384-R-20mm

See page 124 for Accuracy Chart

## R8 Round Collet Sets (Inch)

Set	No. of Collets	Part No.
1/8" - 3/4" x 32nds	21	Z384-SET-5
1/8" - 3/4" x 16ths	11	Z384-SET-6
1/8" - 3/4" x 8ths	6	Z384-SET-7

## R8 Round Collet Sets (Metric)

Set	No. of Collets	Part No.
2mm-20mm x 1mm	19	Z384-SET-1

