

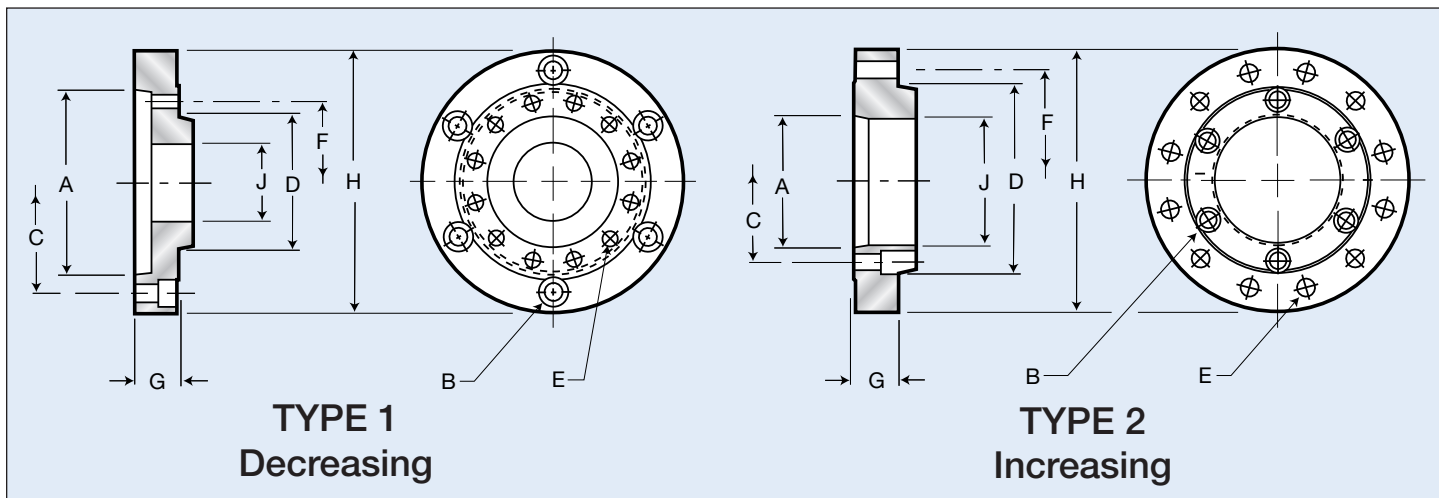

# Atlas Workholding Spindle Conversion Adapters

- ⊕ Made from steel
- ⊕ Dimensions are per USA Standards
- ⊕ Available with UNC or metric mounting bolt holes
- ⊕ Precision CNC turned in the U.S.A.



Part No.	Spindle (Machine)						Chuck					Offset G	Dia H	Hole J
	Type	Mount	A	B(bolt) in.*	B(bolt) mm *	C	Mount	D	E(tap) in	E(tap) mm	F			
A5-A6	2	5	3.250"	7/16	10	4.125"	6	4.188"	1/2x13	12x1.75	5.250"	1.000"	6.500"	2.500"
A5-A8	2	5	3.250"	7/16	10	4.125"	8	5.500"	5/8x11	16x2	6.750"	1.125"	8.250"	3.000"
A6-A5	1	6	4.188"	1/2	12	5.250"	5	3.250"	7/16x14	10x1.5	4.125"	1.500"	6.500"	1.700"
A6-A8	2	6	4.188"	1/2	12	5.250"	8	5.500"	5/8x11	16x2	6.750"	1.125"	8.250"	3.250"
A6-A11	2	6	4.188"	1/2	12	5.205"	11	7.750"	3/4x10	20x2.5	9.250"	1.375"	11.000"	4.000"
A8-A6	1	8	5.500"	5/8	16	6.750"	6	4.188"	1/2x13	12x1.75	5.250"	1.750"	8.250"	2.500"
A8-A11	2	8	5.500"	5/8	18	6.750"	11	7.750"	3/4x10	20x2.5	9.250"	1.375"	11.000"	5.250"
A8-A15	2	8	5.500"	5/8	16	6.750"	15	11.250"	7/8x9	22x2.5	13.000"	1.625"	15.000"	5.250"
A11-A6	1	11	7.750"	3/4	20	9.250"	6	4.188"	1/2x13	12x1.75	5.250"	1.750"	11.000"	2.500"
A11-A8	1	11	7.750"	3/4	20	9.250"	8	5.500"	5/8x11	16x2	6.750"	1.875"	11.000"	3.250"
A11-A15	2	11	7.750"	3/4	20	9.250"	15	11.250"	7/8x9	22x2.5	13.000"	1.625"	15.000"	7.500"
A11-A20	2	11	7.750"	3/4	20	9.250"	20	16.250"	1x8	24x3	18.250"	1.875"	20.500"	7.500"
A15-A8	1	15	11.250"	7/8	22	13.000"	8	5.500"	5/8x11	16x2	6.750"	2.000"	15.000"	3.250"
A15-A11	1	15	11.250"	7/8	22	13.000"	11	7.500"	3/4x10	20x2.5	9.250"	2.250"	15.000"	5.250"
A15-A20	2	15	11.250"	7/8	22	13.000"	20	16.250"	1x8	24x3	18.250"	1.875"	20.500"	11.000"
A20-A11	1	20	16.250"	1	24	18.250"	11	7.750"	3/4x10	20x2.5	9.250"	2.125"	20.500"	5.250"
A20-A15	1	20	16.250"	1	24	18.250"	15	11.250"	7/8x9	22x2.5	13.000"	2.500"	20.500"	8.250"

\* Specify metric or inch requirements when ordering

**NOTE:**

1. Spindle and chuck mountings are outer bolt circle (type A2).
2. "A" and "D" are diameters to sharp corners (large diameter of taper).
3. "B" bolts are a total of 6 equally spaced (60 deg. apart) on a bolt circle of "C".
4. "E" tapped holes are a total of 12 equally spaced (30 deg. apart) on a bolt circle of "F".
5. See standard spindle dimensions on page 88.