

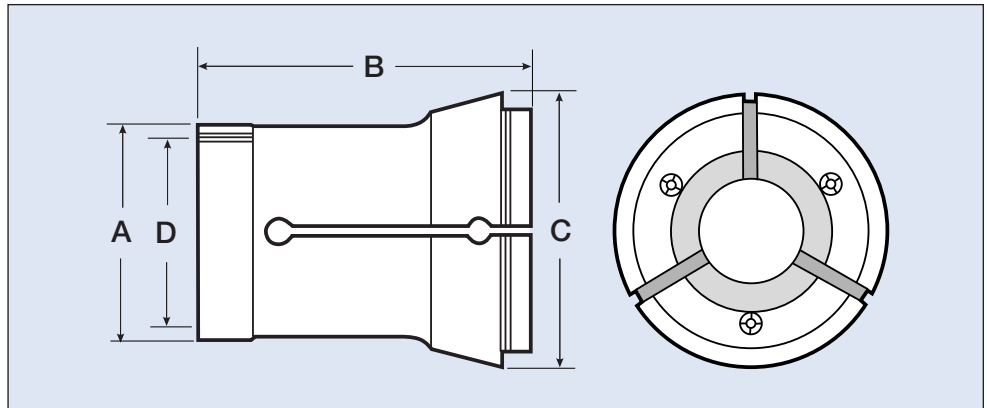

## Crawford Master Collets



Chuck Type	S10	S16	S20	S26
A (mm/in)	48/1.89	48/1.89	60.3/2.38	74.4/2.93
B (mm/in)	93.7/3.67	163.9/6.45	213/8.39	229/9.02
C (mm/in)	59.8/2.35	96.4/3.87	96.3/3.75	125.4/4.93
D (mm/in)	M43 x 1	M43 x 1.75 RH/1.87	M60 x 1.5 RH/2.36	M73 x 1.5 RH/2.87
Capacity Round (mm/in)	25.4/1	41.3/1.63	50.8/2	66.7/2.63
Capacity Hex (mm/in)	21.8/.859	35.7/1.41	43.7/1.72	57.5/2.26
Capacity Square (mm/in)	17.9/.70	29/1.14	35.7/1.4	46.8/1.84
Collet Part No.	D-351	D-352	D-353	D-354



## Pratt Burnerd Chuck Lubricant for Manual and Power Chucks

This is a specially formulated high pressure Chuck Lubricant and is the recommended lubricant to be used in all Pratt Burnerd Chuck that require grease type lubrication.

### Features:

- ⊕ Dramatically improves Chuck jaw forces over conventional lubricants, withstands pressure up to 500,000 pounds per square inch.
- ⊕ Rust and oxidation inhibitors
- ⊕ Tacky nature gives high resistance to centrifugal force.
- ⊕ Contains molybdenum disulfide to reduce seizing, fretting wear galling and lower friction under conditions of extreme pressure.
- ⊕ Help reduce maintenance costs.
- ⊕ An effective lubricant for all brands of chucks

### Ordering Information:

Order No.	Description
PB16OZ	16 oz (453.6 gms) tube
PB10LB	10 lb (4.5 kilo) pail